

PITTSBURG UNIFIED SCHOOL DISTRICT

FOOTHILL ELEMENTARY SCHOOL & HIGHLANDS ELEMENTARY SCHOOL

– PLAY STRUCTURES REPLACEMENT PROJECT

Bid No. 18-001

Addendum No. 1

Friday, March 16, 2018

The Following Changes, deletions, additions, and/or alterations in, on and to the drawings and specifications shall apply to proposals made for and to the execution of the various parts of the work affected thereby.

Careful Note of This Addendum shall be taken by all parties of interest so that the proper allowance may be made in all computations, estimates and contracts, and all trades affected shall be fully advised in the performance of the work which will be required of them.

In Case of Conflict between Drawings, Specifications, and this Addendum, this Addendum shall govern. This Addendum supersedes all previous drawings, specifications, and instructions pertaining to these items.

CLARIFICATION CONSISTS OF THREE (3) PAGES TYPED AND TWO (2) SKETCHES.

I. SPECIFICATIONS CHANGES:

- a. Document 01 11 00 – Summary of Work: At Paragraph 1.02.A., add the following listed scope of work items to the Summary of Work –
 - At Foothill ES, Lower 2 Play Structure – Demolish & dispose of the existing concrete ramp and the concrete curb wall Play Structure Surround.
 - At Foothill ES, Lower 2 Play Structure – Salvage the existing wood fiber Safety Surface material, and then transport it to the City Park on the corner of Alturas Avenue and Riverview Drive in Pittsburg, CA. The material is to then be dumped in a designated area, at the City Park, for spreading by others.
 - At Foothill ES, Lower 2 Play Structure – Furnish & install a new concrete curb wall Play Structure Surround, with chain link fence, as per the attached revised Layout Plan and the attached Concrete Wall Detail Sheet.

- b. Document 01 50 00 – Temporary Facilities and Controls: At Paragraph 1.04.B., add the following information – “Temporary construction fencing is required to be furnished & installed at each one of the three (3) of Play Structure work areas as necessary to prevent unauthorized access to the work areas.”

II. DRAWINGS CHANGES:

- a. NOT APPLICABLE

III. CLARIFICATIONS:

- a. NOT APPLICABLE

IV. ATTACHMENTS:

- a. Find attached a copy of the Sign-In Sheet from the Pre-Bid Conference & Walkthrough held on Thursday, March 08, 2018 – One (1) Page Total.
- b. Find attached a copy of **1)** Revised Foothill Elementary – Lower 2 Play Structure Layout Plan (8-1/2” x 11”), and **2)** Concrete Wall Detail Sheet (11” x 17”).

Pittsburg Unified School District



Signature



Date

 3-16-18

END OF ADDENDUM No. 1

NEW T.O.W.
APPROX. 34"
ABOVE AC
PAVING

NEW T.O.W.
APPROX. 29"
ABOVE AC
PAVING

DEMO EXIST CURB
REPLACE WITH NEW
CURB/WALL AND FENCE

48'-3"

PLAY
SURFACING
1857 SF

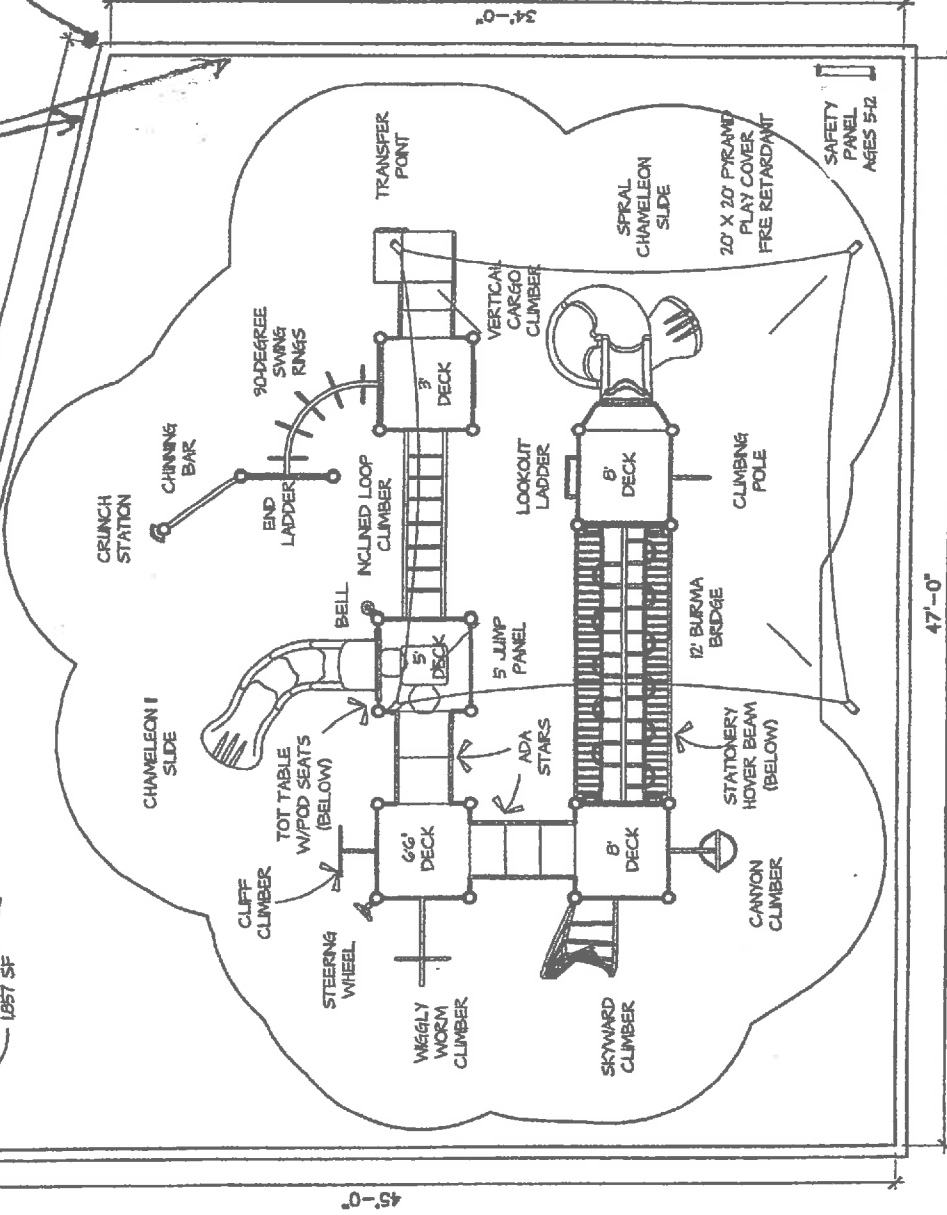

47'-0"

(E) SIDEWALK



ALL DRAWINGS ARE SUBJECT TO CHANGE AND SHOULD BE REVIEWED BEFORE FINAL SALE. ALL SITE OPERATIONS WILL NEED TO BE VERIFIED PRIOR TO SALE AND INSTALLATION.

LINEAR FEET: 174'-3" LF
CRITICAL FALL HEIGHT: 8'-0" CFH

SITE AREA: 1857 SF
SCALE: 1/8" = 1'-0"

DRAWN BY: LDV/DT
DATE: 2-12-2023

Foothill Elementary - Lower 2
Pittsburg, CA

FENCE NOTES:

1. PROVIDE 48" GALVANIZED FENCE ALONG TOP OF NEW CURB/WALL.
2. GALVANIZED POST SLEEVES SHALL BE EMBEDDED 24" INTO WALL. WHERE CURB/WALL IS LESS THAN 28" IN HEIGHT, FROM BOTTOM OF FOOTING TO TOP OF WALL, THE POSTS SHALL BE INSTALLED IN A 12" ROUND BY 27" DEEP POST FOOTING, WITHOUT A SLEEVE, BELOW BOTTOM OF CURB/WALL. CURB/WALL SHALL THEN BE POURED TIGHT AROUND THE POSTS.
3. POSTS SHALL BE EVENLY SPACED ALONG EACH SIDE OF THE PLAY AREA, 10' MAX. SPACING.
4. 2" GALVANIZED CHAIN LINK FENCE FABRIC SHALL BE INSTALLED ON THE INSIDE OF THE POSTS, TOWARD THE PLAY AREA.
5. PROVIDE TOP AND BOTTOM RAIL.

ADDITIONAL TURF NOTES:

1. TURF SHALL BE INSTALLED LEVEL WITH EXISTING SIDEWALK.
2. SLOPE TURF AREA MAX. 2% TOWARDS THE NORTH, AWAY FROM THE SIDEWALK. AREA SHALL BE LEVEL EAST/WEST DIRECTION, EXCEPT ALONG SIDEWALK. THERE IS A 3/4" ELEVATION DIFFERENCE IN THE SIDEWALK LENGTH.
3. TRENCH DRAIN SHALL BE 4" PVC SCH. 40 PERFORATED PIPE, SLOPED TO DRAIN WEST, WITH THE PIPE EXTENDING THROUGH THE CURB/WALL, 3/4" CRUSHED ROCK, WRAPPED IN DRAIN FABRIC.

ADDITIONAL WALL NOTES:

1. SPREAD FOOTING NOT REQUIRED FOR CURB/WALL, WHERE HEIGHT IS LESS THAN 12" ABOVE ADJACENT GRADE.
2. PROVIDE 8" WIDE TALL CURB WHERE SPREAD FOOTING IS NOT REQUIRED, WITH 12" OF DEPTH BELOW ADJACENT GRADE, PROVIDE #4 REBAR SAME SPACING AS WALL REBAR.

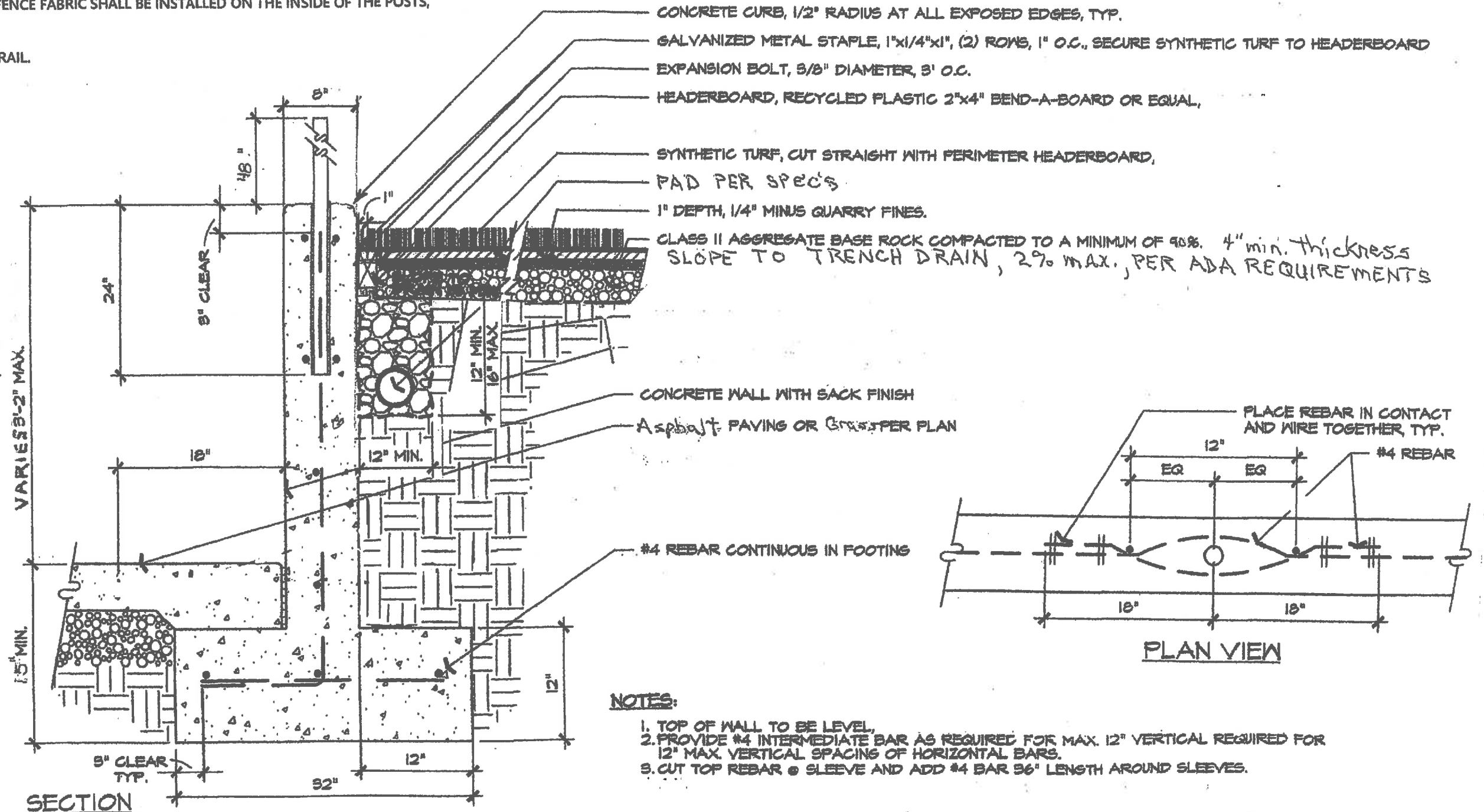

NOTES:

1. TOP OF WALL TO BE LEVEL.
2. PROVIDE #4 INTERMEDIATE BAR AS REQUIRED FOR MAX. 12" VERTICAL REQUIRED FOR 12" MAX. VERTICAL SPACING OF HORIZONTAL BARS.
3. CUT TOP REBAR @ SLEEVE AND ADD #4 BAR 96" LENGTH AROUND SLEEVES.

CONCRETE WALL